

Decontamination Of Clinical Records, Materials And Devices

I. Cleaning & Disinfection of Impressions & Interocclusal Records Prior to Lab work (*wear gloves*)

- Remove any cotton rolls embedded in the impression material.
Rinse thoroughly with water, gently shake to remove excess water.

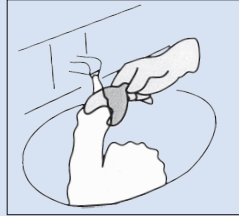

- Wet with disinfectant (OPTIM 33TB) to coat all surfaces.

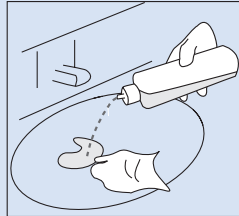

- Place in sealed plastic bag.

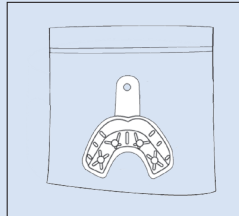

- After 3 minutes contact time, rinse thoroughly to remove disinfectant.

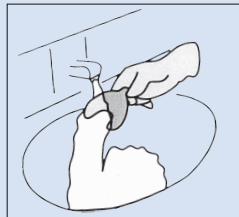

II. Orthodontic Appliances, Prostheses & Prosthodontic Materials which have been in the patient's mouth.

A. Prior to lab adjustments (*wear gloves*)

- Rinse with water to remove blood and gross debris.
- Wet with disinfectant (OPTIM 33TB) to coat all surfaces.
- Place in sealed plastic bag.
- After 3 minutes contact time, rinse thoroughly to remove disinfectant.

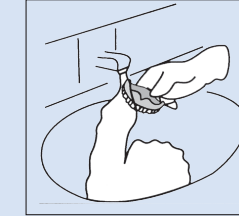
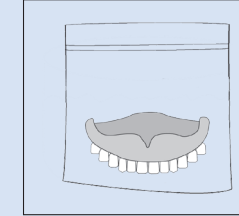
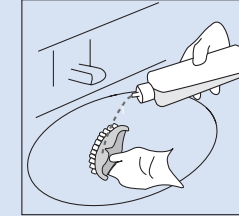
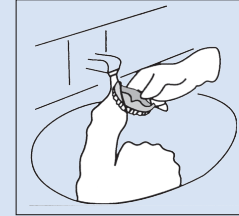

B. Adjustments (*Clinic gloves, Lab no gloves*)

Grinding:

- Use sterilized acrylic burs and handpiece for adjusting prosthesis.
- Rinse the prosthesis thoroughly before inserting in the patient's mouth.

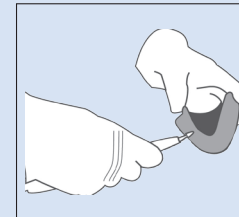

Polishing:

- Don't wear gloves while using lathe.
- Use a new rag wheel for each case.
- Use a unit dose of pumice, wet with water to make a slurry.
- Polish prostheses.
- Discard rag wheel & remaining pumice.
- Rinse the prosthesis thoroughly before inserting in the patient's mouth.

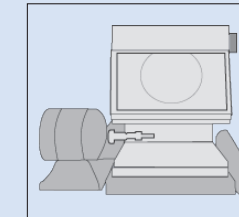

Prior to Use of Steam Cleaner and Sandblaster:

- Rinse and disinfect item.

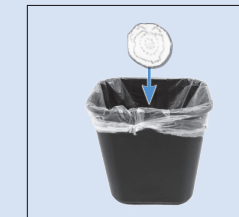

III. Casts (*Disinfect after contact with clinical records/prostheses - wear gloves*).

- Wet with disinfectant (OPTIM 33TB) to coat all surfaces.
- Place in sealed plastic bag.
- After 3 minutes contact time, allow to air dry.

